



Downpipes

Overview

Metal downpipes are the finishing touch to any quality rainwater installation.

Specifier Notes

Down pipe capacity, both in size and number, determine how effective any rainwater system is. Downpipes should be distributed evenly around the rainwater system and their design and specification should allow for maximum rainfall situations.

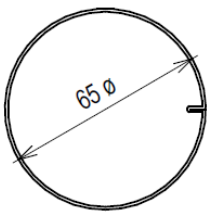

CG 65 \varnothing Downpipe

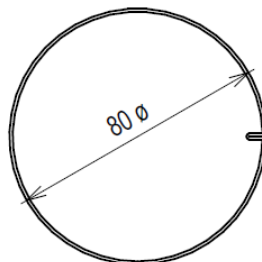

CG 80 \varnothing Downpipe

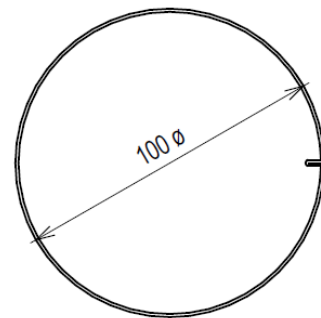

CG 100 \varnothing Downpipe

Quick Reference Data

	Material Availability	Bracket Types	Bracket Material
Downpipes	0.50mm Copper	Strap Brackets*	Copper
	0.5mm MagnaFlow	Munzing Rings	Alumigard
			MagnaFlow

*Straps are supplied in the same material as the downpipes for Continuous Group standard colours.
Eg: an Ironsand MagnaFlow pipe installed with straps will have Ironsand MagnaFlow Straps.

(100mm straps are only available in copper. All other 100mm downpipes are fixed with munzing rings.)