

## Spouting / Wall Junction

- NOTE: (1) The upstand at the lower edge of the *apron flashing* may be preformed to a larger size and then trimmed on site to suit.  
(2) The transition *flashing* bridges gap at the end of the fascia to protect the soffit *framing*.  
(3) *Wall underlay* omitted for clarity.

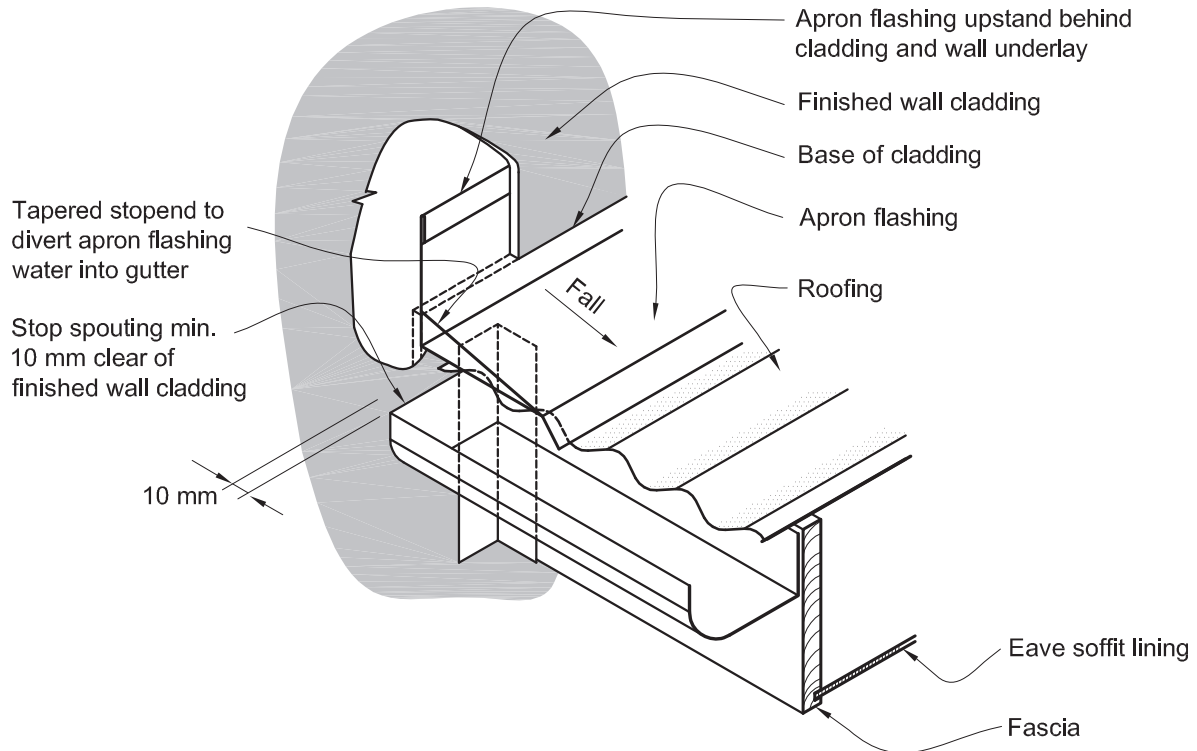

## Gutters, barges & fascia

Where eaves, spouting, barges or fascias terminate against claddings, these shall be installed after the wall cladding and after any protective finishes have been applied.

Eaves, spouting, barges and fascias shall terminate so as to leave a gap of 10mm from the finished wall cladding.